

# Fuel Injection Technology

OWNER' S 50 MANUAL  
MOTORCYCLE

# Fuel Injection Technology

MOTORCYCLE

**Please consult the instruction manual before use. Do not use the electric motorcycle without understanding its characteristics.**

**Dear user:**

Thank you for purchasing our Jiajue brand electric motorcycle series. We are deeply grateful. To ensure your safe and comfortable riding, please read carefully all the information recorded in this manual. Regular inspection and maintenance are essential for every ride. When regular maintenance is required, please visit the designated service station for maintenance and repair work.

All contents recorded in this manual, if changed, shall be subject to the actual vehicle without further notice.

**Special Notice:** For the happiness of yourself and your family, please be sure to read and adhere to the following guidelines: 1. Do not rush to use an electric motorcycle before understanding its basic characteristics and driving operation methods.

2. Please ensure to comply with traffic regulations and refrain from lending your vehicle to individuals who are unable to operate electric motorcycles.

3. Electric motorcycles are classified as motor vehicles. Please refrain from driving without a license, and

avoid entrusting the vehicle to minors, pregnant women, or individuals with limited mobility. Do not operate an electric motorcycle under the influence of alcohol or medication.

4. If the power supply is damaged or the charging system malfunctions, it should be replaced or repaired at a repair shop designated by the manufacturer.

5. Discarding discarded lead-acid batteries carelessly can cause pollution to our home environment. Therefore, it is essential to hand over waste batteries to businesses for unified disposal, and let's jointly care for our home.

## Catalogue

Introduction to complete vehicle components	1	Maintenance inspection	22
Introduction to operation and driving functions	2	Vehicle cleaning	24
Electrical circuit diagram	9	Vehicle storage	25
Use and maintenance of main components	10	Regulations on three-guarantee service items and duration	26
Common fault analysis and handling	14	Complementary Three Guarantees Service Items	27
After-sales service explicitly stated	16	Note	28
Maintenance and warranty	17	Not within the scope and content of the "Three Guarantees"	29
Customer Satisfaction Program	18	Main parameter specifications	30
Notice to Users	20	Maintenance Record	31
Vehicle maintenance	21	Three Guarantees Service Registration Card	32

# 1. Introduction to complete vehicle components

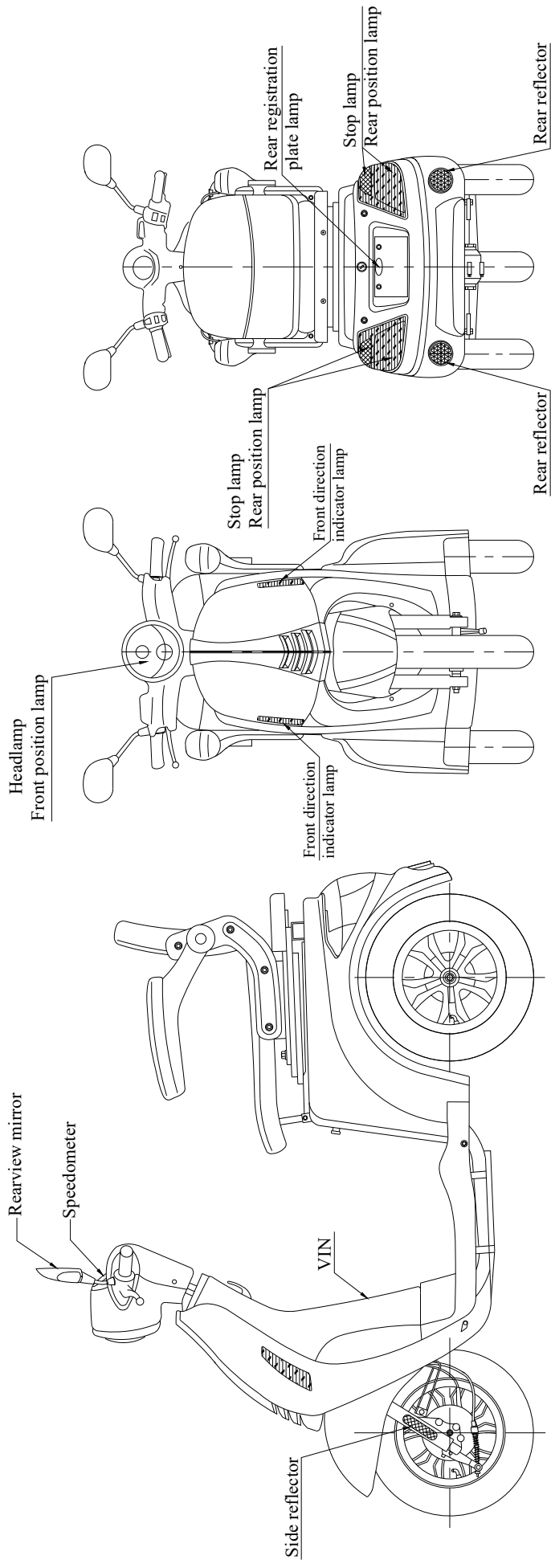

## 2. Introduction to operation and driving functions

### **(Pre-driving inspection for vehicle safety)**

**Brake:** Check whether the brake lever is powered off normally and whether the braking performance is sensitive.

**Tyre:** Check if the tire pressure is sufficient.

**Speed control handle:** Check whether it rotates flexibly and whether the return function works properly.

**Loudspeaker:** Check if the function is normal.

**Signal lights:** Check whether the turn signals and headlights are functioning properly.

**Handlebar steering:** no play, no looseness, check for steering flexibility.

**Battery:** Check the battery voltage display to see if it is sufficient. Insufficient charging not only affects the riding range but also shortens the battery life. Please lock the battery after installation

The pool lock prevents the battery from being stolen.

On rainy days, you should pay extra attention to safety. The wet road surface poses a hazard to your electric motorcycle driving. Avoid steering during acceleration; maintain a safe distance from the vehicle ahead; remember that the braking distance in rainy weather is twice longer than usual, and avoid emergency braking; pay special attention to traffic signs.

When driving on roads with poor lighting conditions at night, make sure to turn on headlights. For luxury cars, use

high beams at high speeds and low beams at low speeds. When passing intersections or making turns, slow down, use low beams, and signal with your turn signals.

Severe overload of electric motorcycles can lead to tire deformation and damage to front and rear shock absorbers. Overloading the motor can seriously affect the steering flexibility and braking reliability, greatly reducing the safety of electric motorcycle driving. It is recommended that your maximum load weight be less than 150kg. If this is unavoidable, please check whether the minimum ground clearance and roll angle of the electric motorcycle are appropriate. If the load is too heavy or the load volume is too large, the safety factor will drop significantly. At the same time, you should check whether the loaded items are secure, whether they hinder temporary parking, and whether they affect steering or other operational actions.

Please, under the premise of ensuring safety, try not to brake or start frequently. In case of any situation, please use the brake to cut off power in advance, or slow down by coasting and then apply the brake.

This vehicle is not afraid of rain and snow, but it should not wade through water deeper than the motor shaft.

Please refrain from using non-original chargers provided by our company for charging, otherwise, we will not be held liable for any accidents that may arise.

Your driving skills and knowledge of electric motorcycles are the foundation for safe driving. If you are driving an electric motorcycle for the first time, please practice in an open area and fully master the driving skills. Do not ride with one hand.

## **Function Introduction : Operation method**

Electric motorcycles are classified as motor vehicles. Please ensure you ride on motor vehicle lanes, refrain from cutting in on non-motorized vehicle lanes, and consciously abide by traffic rules.

Install the battery, turn on the power, and the instrument's "ready" indicator light will illuminate, indicating that it is in a "rideable state". Then, carry out the "pre-ride inspection" work.

When riding, rotate the throttle grip counterclockwise, and the motor speed will increase from slow to fast until it reaches the maximum speed. The optimal speed can be achieved.

When the motor starts, it emits a "buzzing" sound, which is the vibration sound of the efficient magnetic field and is a normal resonance. When the motor speed reaches its optimal level, the sound completely disappears.

After use, please turn off the power and remove the key (add a lock if there is a head lock). When storing or parking, ensure it is supported stably and locked for security!

When storing for a long period, please fully charge the battery and keep it in a cool and dry place, and insist on charging it once every half a month.

## Function Introduction : power lock

The power switch lock has two keys. Please keep the other key as a spare and store it securely. To use, insert the power lock key into the lock hole and turn it clockwise to the "ON" position. At this point, the power display light on the dashboard will illuminate, indicating that the power supply is connected to the control circuits. When parking, turn the key counterclockwise to the "OFF" position to turn off the main power. When storing the vehicle, push the key and lock cylinder about 3mm into the power lock and turn it counterclockwise to the "LOCK" position to remove the key. Lock the handlebar securely!

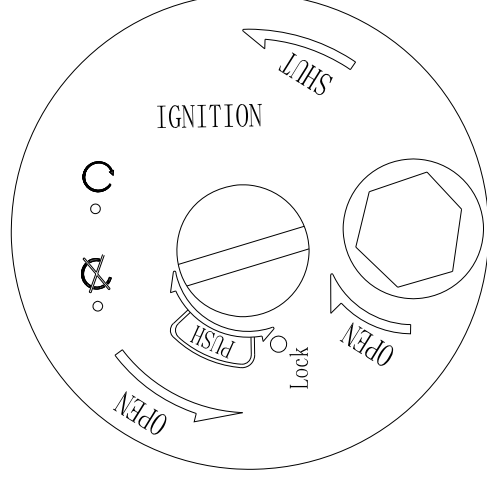

## Function Introduction : storage box

Open the storage box and insert the key (the same key as the power lock) into the power supply (As shown in the right figure) For the lock hole, rotate it counterclockwise until you hear a "click" sound. The cushion can be lifted to reveal the storage box hidden underneath (as shown in the lower right image). Please do not place flammable and explosive items in the storage box. If the charger needs to be placed in the storage box, the storage box must be properly shockproofed, and can be stored with additional packaging to prevent moisture.

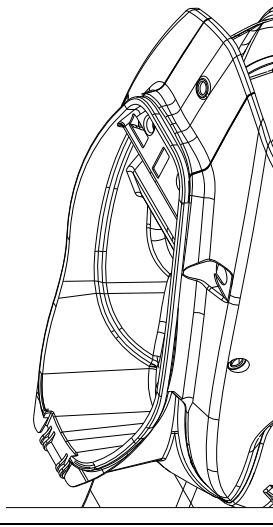

### **Function Introduction : toolbox**

The front storage box is located under the front of the car and is used for temporarily storing some small items, Do not place valuables in this box.

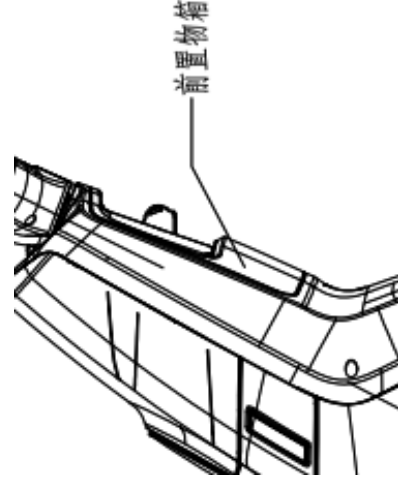

### **Function Introduction : Variable speed brake system**

The left brake lever is for the rear brake, while the right brake lever is for the front brake. Both brake levers are equipped with an automatic power-off system. For general braking, please use the rear brake, and for emergency braking, use both the front and rear brakes together. Do not use the front brake alone to ensure the stability of the braking system. The handlebar features a stepless speed control, and please allow the handlebar to automatically reset when braking.



## Function Introduction : Sound and Light Control System

On the left side of the handlebar are the controls for the headlight's high and low beams and the turn signals. When driving at night, please keep a safe distance between vehicles and avoid using the high beam for extended periods. If there is an oncoming vehicle, please switch to the low beam to avoid blinding the other driver. When changing lanes or making a turn, please use the turn signals in advance to ensure your driving safety. Below is the horn switch.

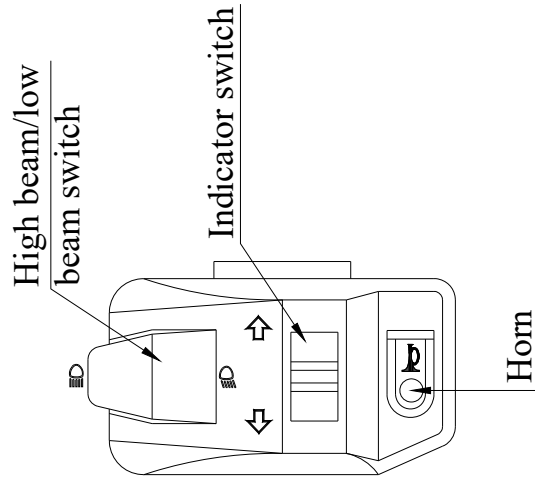

The right side of the handlebar is for the gear and horn switches

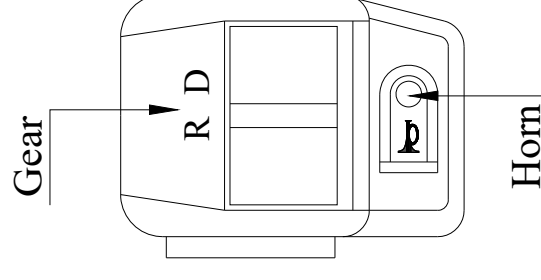

## Function Introduction : Vehicle Condition Indication System

The system visually displays the operational status of various functions of the entire vehicle. The battery gauge is equipped with an undervoltage protection device. When the battery voltage is insufficient, the gauge pointer will point to the red zone, and the undervoltage protection will automatically cut off the power supply. At this time, charging should be carried out immediately, otherwise it will affect the battery life.

When an electric motorcycle is starting, the voltmeter shows significant voltage fluctuations, which is normal. To accurately check the remaining battery level, it is recommended to read it while driving steadily.

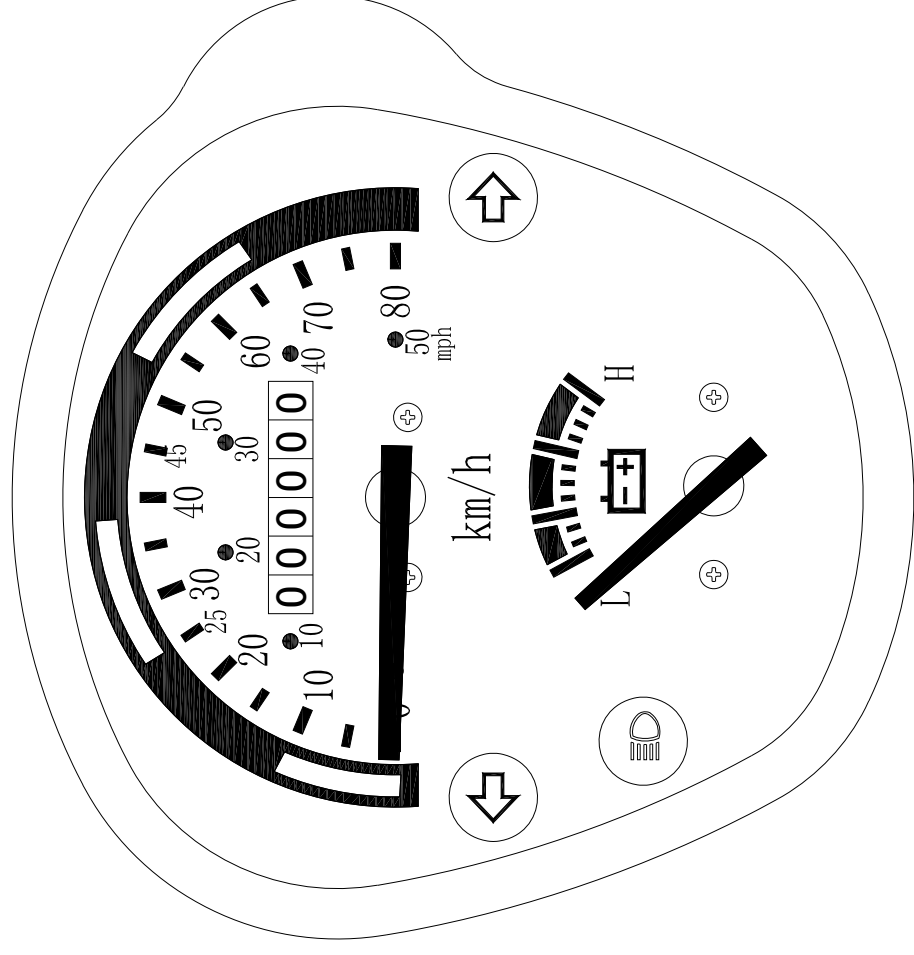

### 3. Electrical Circuit Diagram

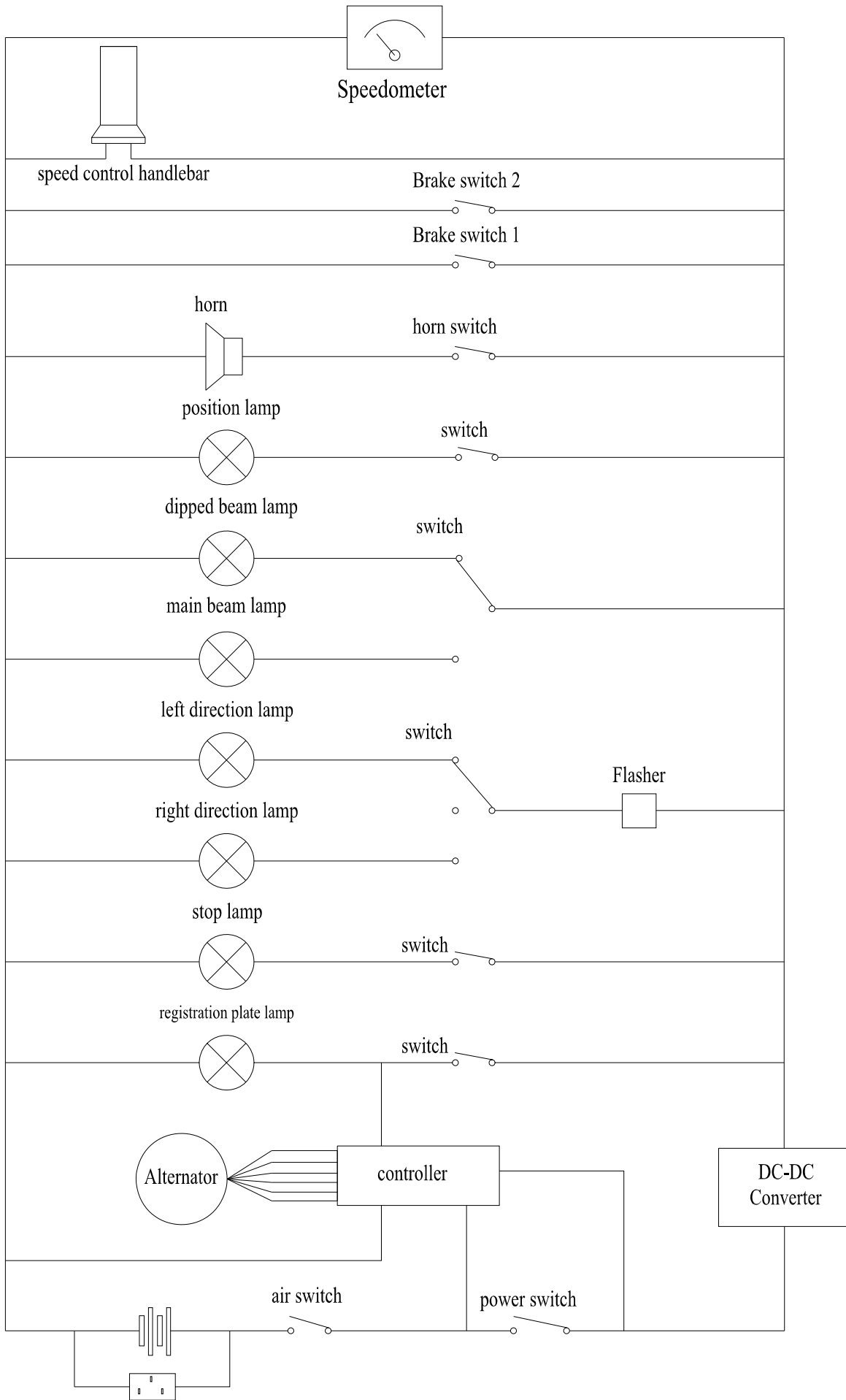

#### 4. Use and maintenance of main components

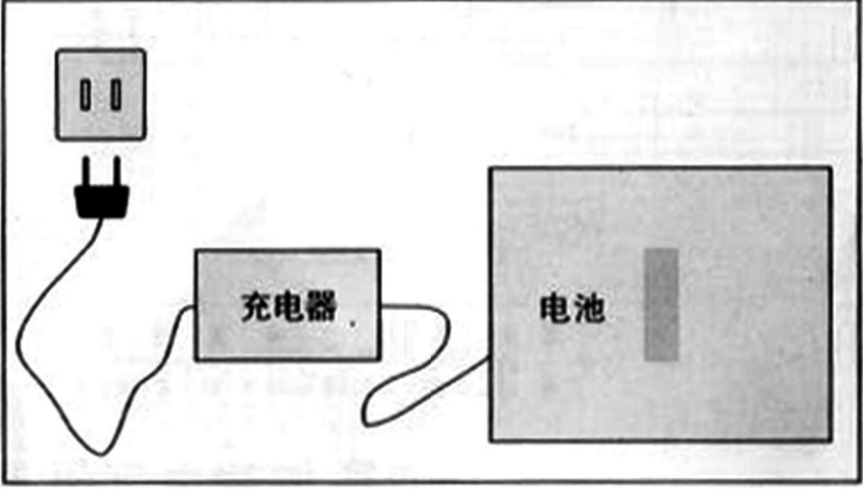
<p><b>Use and maintenance of charger (For indoor use only, keep away from rain)</b></p>	
<p>The charger is a crucial component for recharging the battery. Our company adopts a three-stage negative pulse charging method, which eliminates the need for dedicated monitoring during charging. It can be conveniently used anywhere there is a 220V AC power source.</p> <p>When charging directly on the vehicle, please turn off the power lock of the electric motorcycle. First, insert the charger's output plug into the charging socket on the vehicle. Then, plug the charger's input power plug into a mains AC220V socket. Make sure to place the charger in a dry and ventilated area.</p> <p>When you need to remove the battery for charging, first plug the charger's output plug directly into the battery charging socket, and then plug the charger's input power plug into the mains AC220V socket.</p> <p>There are two charging indicator lights. When the plug is properly</p>	 <p>The diagram illustrates the charging setup. On the left, a power source (represented by a wall outlet symbol) is connected to a rectangular box labeled '充电器' (Charger). A cable connects the charger to a larger rectangular box on the right labeled '电池' (Battery). The battery box has a horizontal bar on its front face, representing the battery terminals.</p>

connected, both lights will be red, indicating that charging is in progress. When one of the red lights turns green, it signifies that the battery is almost fully charged and has entered a maintenance state of "float charging" with microcurrent. At this point, it is best to continue charging for another 2 hours or so, but generally, the maximum continuous charging time should not exceed 12 hours. (If the charger still does not turn off the light after being charged for 12 hours, please stop charging in time and send it to the repair department for inspection.) The intelligent charger is constantly improving, and the status indicator light changes. Please read the charger manual carefully before use.

**Precautions:**

A Please do not use non-original chargers or other accessories provided by our company, otherwise we will not be responsible for any damage caused. In some areas where the grid voltage is unstable, when the grid voltage fluctuation exceeds  $AC220V \pm 20$ , it is recommended to use a low-power voltage regulator, otherwise it may cause insufficient charging or damage to components.

When using and storing the charger, prevent liquids, metal, and non-metal debris from infiltrating the charger's

interior. Be cautious to avoid dropping or impacting it, as this may cause damage.

When charging, please place it in a safe location where children cannot reach; when removing the battery for charging, do not touch the poles of the battery with your hands, and do not make contact with conductive objects to avoid short circuits and potential accidents.

E. This charger is designed for indoor use. Please use it in a dry and well-ventilated environment. Do not cover the charger with any objects while it is charging. The charger generates a certain amount of heat during use, so it must be kept at least 0.5 meters away from flammable items.

The charger contains high-voltage circuits, so please do not disassemble it without authorization.

When carrying the charger, avoid jolting or colliding with it, as this may cause damage; as the temperature drops in winter, the driving range may decrease, which is a normal phenomenon.

#### **Use and maintenance of batteries :**

The battery is equivalent to the "fuel tank" of a car, both serving as a place to store energy, with the difference being that the battery stores electrical energy. As the number of charging and discharging cycles increases, its capacity gradually decreases. In this sense, batteries are consumables. The rate of this capacity decrease is directly related to whether a dedicated battery is used, whether the battery is used correctly, whether the vehicle condition is good, and whether a dedicated charger is employed.

To ensure that our battery serves you for a longer period of time, please do not use or store the vehicle in a depleted state without charging. If you start the vehicle by stepping on the pedal or pushing it, and then rotate the handlebar, reducing "zero-start" can effectively extend the battery life.

Experiments have shown that proper usage can effectively extend battery life. For new vehicles, if driven less than 15-20km per day, charging once every two days is sufficient. However, if driven more than 15-20km per day, daily charging is necessary. After six months, the frequency of charging can be appropriately increased based on the degree of battery capacity decline.

Due to the characteristics of lead-acid batteries, when the ambient temperature drops below  $-10^{\circ}\text{C}$ , the battery capacity may also decrease. Therefore, it is recommended that in colder regions, after riding, the battery should be partially taken to a warm place for charging and storage.

After the service life of the lead-acid battery ends, do not discard it casually, as it may cause environmental pollution. Instead, you should visit the Jiajue After-sales Service Center for a 1:1 replacement, and the dealer will collect and return it to the factory for disposal. Protecting the environment is everyone's responsibility.

#### **Use and maintenance of electric motor:**

Ordinary brushless electric hub motors do not require special maintenance. However, for brushed electric hubs, after 2000 hours of cumulative operation on electric motorcycles, please visit the Jiajue Service Center for

maintenance, which includes checking the wear status of the carbon brushes inside the motor, inspecting the wear status of the reduction mechanism, and replacing the mechanical lubricant.

When the electric motor is engaged to move the electric motorcycle in reverse, it may feel like the rear wheel is moving backward with a heavier sensation. Additionally, there may be a slight noise inside the wheel hub when the electric motorcycle is propelled forward. Both of these are normal phenomena.

Please pay attention to checking the fastening status of the electric hub mounted on the rear fork during the use of your electric motorcycle. If you find any loose nuts, tighten them immediately or have them checked and dealt with by a professional.

#### **Use and maintenance of the controller:**

The controller used by our company features multiple functions such as anti-runaway, undervoltage protection, and ABS electromagnetic braking. In the event of a throttle handle connector detachment or malfunction, there is no risk of runaway and subsequent collision. ABS electromagnetic braking enhances the reliability of braking, allowing consumers to use it with confidence.

## 5. Common fault analysis and handling

Common fault phenomena	cause of failure	exclusion method
When the power is turned on, the instrument shows no display and the speed is not adjusted.	<ol style="list-style-type: none"> <li>1. The power lock switch is damaged and the plug-in is in poor contact.</li> <li>2. The power plug and battery socket are in poor contact, causing sparking.</li> <li>3. Open circuit of fuse.</li> </ol>	<ol style="list-style-type: none"> <li>1. Replace the power lock or connector.</li> <li>2. Replace the power plug or battery socket.</li> <li>3. Find out the cause and replace the fuse.</li> </ol>
The power is connected, the instrument displays normally, but the speed is not adjustable.	<ol style="list-style-type: none"> <li>1. Battery undervoltage.</li> <li>2. The speed control handle is damaged.</li> <li>3. The left or right power-off brake handle is malfunctioning.</li> <li>4. Controller and motor malfunction.</li> </ol>	<ol style="list-style-type: none"> <li>1. Fully charged.</li> <li>2. Replace the speed control handle.</li> <li>3. Replace the power-off brake handle.</li> <li>4. Repair or replace the controller and motor.</li> </ol>
The battery cannot be charged or is not fully charged.	<ol style="list-style-type: none"> <li>1. The battery fuse is burnt out.</li> <li>2. Poor contact inside the fuse box.</li> <li>3. Charger malfunction.</li> <li>4. The charger is not plugged in properly.</li> <li>5. The charger indicator light is displaying abnormally.</li> <li>6. Battery life has reached its end.</li> </ol>	<ol style="list-style-type: none"> <li>1. Replace the fuse.</li> <li>2. Adjust the position and remove the internal oxide layer.</li> <li>3. Replace electrical appliances.</li> <li>4. Check and replace the plugboard.</li> <li>5. Replace the charger.</li> <li>6. Replace the battery.</li> </ol>
The subsequent mileage after one charge is insufficient.	<ol style="list-style-type: none"> <li>1. The battery is not fully charged.</li> <li>2. Insufficient tire pressure.</li> <li>3. The battery is aged or damaged.</li> <li>4. There are many uphill sections, strong headwinds, frequent braking, and heavy loads.</li> <li>5. Brake wear.</li> </ol>	<ol style="list-style-type: none"> <li>1. Fully charge the battery or check if the charger plug is poorly connected.</li> <li>2. Adequate air.</li> <li>3. Replace a set of batteries.</li> <li>4. Try to minimize the frequency of braking and starting.</li> <li>5. Adjust the brakes.</li> </ol>
The battery won't charge.	<ol style="list-style-type: none"> <li>1. The connection between the charger plug and the battery socket is loose.</li> <li>2. The battery pack wiring has come loose.</li> <li>3. Charger malfunction.</li> </ol>	<ol style="list-style-type: none"> <li>1. Replace the plug or socket.</li> <li>2. Weld the connecting wire.</li> <li>3. Repair or replace the charger.</li> </ol>
When the motor does not rotate or fails to switch between high and low speeds.	<ol style="list-style-type: none"> <li>1. The motor phase line is broken.</li> </ol>	<ol style="list-style-type: none"> <li>1. Reweld, rewrap, or replace the motor.</li> </ol>

## **6. After-sales service is clearly stated**

We kindly request that you accurately fill in the customer information on the three-guarantee service certificate when purchasing your vehicle, so that we can promptly provide you with excellent after-sales service.

This manual is applicable to the Jiajue electric motorcycle series. If there are any changes in specifications and models that do not match the illustrations in this manual, no further notice will be given.

The final interpretation of this manual belongs to Zhejiang Jiajue Motorcycle Manufacturing Co., Ltd. No individual or organization is authorized to reproduce the relevant content and image materials without permission.

Lastly, we sincerely welcome your valuable suggestions regarding Jiajue electric motorcycles!

# Maintenance and repair

## Customer Satisfaction Program

Your satisfaction is of utmost importance to us at Jiajue. Typically, any issues related to vehicle repair, usage, and maintenance will be handled and resolved by the authorized after-sales service center of Jiajue electric motorcycle dealers. Sometimes, despite having the best intentions for everything, misunderstandings may still arise. If your issue is not satisfactorily resolved, you can follow the steps below:

### Step 1:

Discuss your issue with the management personnel of the local authorized after-sales service center for Jiajue electric motorcycles. Typically, discussing with the business personnel of the Jiajue electric motorcycle authorized after-sales service center can quickly resolve your issue.

### Step two:

If you still have questions after the matter has been reviewed by the center manager, you can contact the after-sales service department of Zhejiang Jiajue Motorcycle Manufacturing Co., Ltd. (phone number on the back cover). When you are confused about some issues related to Jiajue electric motorcycles, we encourage you to call us so that we can provide you with accurate answers to your inquiries.

When you call, please provide the following information to the After-sales Service Department of Zhejiang Jiajue Motorcycle Manufacturing Co., Ltd. for timely processing:

1. Your name, address, and home or company phone number
2. The date and place of your vehicle purchase
3. The specific issue

This manual describes important information about vehicle quality assurance and the free service items we provide for you. Please read it carefully and keep it properly.

## **Notice to Users:**

Dear user:

First of all, thank you for choosing "Jiajue" electric motorcycles! "Your choice - is the beginning of our service!" In the days to come, "we" will accompany you to "stroll" through a wonderful life together!

To ensure your rights and interests, as well as the normal use of your car, please read and adhere to the provisions stated in the user manual and warranty certificate before use. In accordance with the relevant provisions of the "Product Quality Law of the People's Republic of China" and the "Law of the People's Republic of China on the Protection of Consumers' Rights and Interests", our company has formulated the following detailed rules for the "Three Guarantees". To effectively protect your legitimate rights and interests and improve the civil liability system for product quality, please fill out this certificate carefully and keep it properly. With this certificate, you can enjoy corresponding services at the motorcycle service center designated by the vehicle sales unit, Zhejiang Jiajue Motorcycle Manufacturing Co., Ltd.

## **Vehicle maintenance:**

For the happiness of you and your family, please be sure to read and adhere to the following terms: 1. Newly purchased vehicles must be taken to the service center of Zhejiang Jiajue Motorcycle Manufacturing Co., Ltd. for the first free maintenance within 15 days of use or after driving 200-500 kilometers. The service center will provide free specialized maintenance supplies and professional technicians for the maintenance. Both the cost of maintenance materials and labor hours are free of charge.

After the first maintenance, you should return to the service center of Zhejiang Jiajue Motorcycle Manufacturing Co., Ltd. for maintenance every 3,000 kilometers or every 6 months.

3. Please ensure that you use original accessories provided by Jiajue electric motorcycles, and refrain from unauthorized modifications or changes to the original design.

4. The professional technicians at the service center of Zhejiang Jiajue Motorcycle Manufacturing Co., Ltd. have undergone professional training and are capable of providing you with standardized technical services, as well as original accessories for Jiajue electric motorcycles and free consultation. Please ensure that you adhere to regular maintenance at the local service center of Zhejiang Jiajue Motorcycle Manufacturing Co., Ltd.

## Maintenance Inspection

### Regular maintenance plan for Jiajue electric motorcycle

adjust	A. Sturdy	B. Replace	C	Cleaning and maintenance	D	Lubrication	E
NO.	inspection items		30 days	inspection items	One year	3 year	5 year
1	Is the handlebar properly fitted and sturdy.		AB	B	BD	AB	B
2	When the handlebar is rotated, check whether the steering components move and whether they are worn.		ABE	BE	ABCE	ABE	BE
3	The installation, wear, and air pressure status of the tires.		AB	AD	ABCD	ABCD	ABCD
4	Check whether the front axle, front fork shaft bracket, and ball retainer are loose or worn.		ABE	ABDE	ABDE	ABCE	ABCE
5	Is the installation position and operational condition of the brake system in good condition.		ABD	ABD	ABCD	ABCD	ABCD
6	Is the brake pad worn or detached.		ABD	ABCD	ABCD	ABCD	ABCD
7	Is the wheel rim deformed.		ABD	ABCD	ABCD	ABCD	ABCD
8	Check the installation of the front and rear mudguards and plastic parts to see if they are loose or damaged.		ABD	ABD	ABD	ABD	ABD
9	Is the front fork of the frame deformed or damaged, and is the installation secure		ABDE	ABDE	ABDE	ABDE	ABDE
10	Can the horn, headlights, and signal lights work normally		AD	ACD	ABD	AD	ABD
11	Installation and operation of the motor		ABDE	ABDE	ABDE	ABDE	ABDE
12	Inspection of the installation and operational status of tail lights or reflectors		AD	AD	ABD	AD	ABD
13	Inspection of the installation status of car locks and other fastening components		ABDE	ABDE	ABCDE	ABDE	ABDE

※If you can follow the maintenance plan below, it will extend the lifespan of your vehicle.

## **Maintenance Inspection:**

Check and tick off each item.

- 1. Confirmation of overall vehicle performance issues (confirmation and registration of customer-reported phenomena)
- 2. Whether the height of the handlebars and seat cushion meets customer and standard requirements.
- 3. Check whether the handlebar rotation and steering parts are flexible and free from wear.
- 4. The main screws of the front and rear axles, as well as the rear wheels, must be reinforced.
- 5. Whether the installation positions and operational conditions of all components of the braking system are in good condition.
- 6. Whether the rotation of the front and rear wheels is in good condition, and whether the air pressure is adequate.
- 7. Check whether the spokes are loose or broken.
- 8. Whether the lighting system, horn, reflector, and other safety facilities are working properly.
- 9. Installation status of the car lock and other components. The screws of the entire vehicle must be checked and reinforced.

### **Vehicle washing:**

We recommend that you regularly clean your electric motorcycle to maintain its appearance cleanliness and inspect important components for wear and damage.

1. To prevent residual detergent from rusting alloy parts, rinse the car thoroughly with clean water from top to bottom after cleaning;
2. When cleaning plastic parts, use a soft cloth or sponge dipped in an aqueous solution of mild detergent to clean. Gently wipe away the stained areas, rinse repeatedly with clean water several times, and wipe clean with a dry cloth;
3. It is prohibited to use high-pressure water jets for cleaning to avoid potential malfunctions caused by water entering and short-circuiting the internal electronic components and circuits. When cleaning plastic parts, please use neutral detergent. After cleaning and drying the electric motorcycle, lubricate the moving parts such as the front axle in a timely manner. It is strictly prohibited to apply oil to the front and rear brakes, rims, and tires.

## **Vehicle storage:**

If you plan to park your electric motorcycle for an extended period, please perform proper maintenance before storage to prevent rusting, malfunction, or damage to moving parts.

1. Vehicles stored for a long time need to be inspected every three months, and parts that require lubrication should be maintained;

2. Remove the battery, fully charge it, store it in a cool and dry place, and supplement it once a month according to the battery maintenance rules. Safety must be taken into account;

3. Store the vehicle in a cool, dry place with minimal temperature fluctuations, and cover it with a cloth. Regularly check whether the tire pressure is normal and replenish it as necessary;

Before resuming normal operation, conduct a comprehensive maintenance on the entire vehicle and test-ride it in an open area with few vehicles. Only use it after confirming that all performance is normal.

## Regulate the three-guarantee service items and their terms:

Name	Fault	three guarantees period	depreciation rate	Remarks
motor	The bearing is broken, the casing is cracked, and the winding is burnt	3 years	For items that do not meet the return or exchange criteria, a depreciation fee will be charged according to the following standards: 3% for batteries and 1% for other components.	The "three guarantees" refer to the replacement of damaged parts caused by quality issues due to design, manufacturing, processing, and other reasons. Damage caused by human factors and other factors is not covered by this warranty.
frame, fork	Fracture or desoldering	One year		(The aluminum wheel rims of the motor are not covered by the "three guarantees" for the motor. The battery is replaced with a new one during the first half of the warranty period, and the battery is maintained during the second half.)
controller	performance failure	One year		
charger	performance failure	One year		
battery	Less than 60% capacity	6 months		

**Comes with three-guarantee service items as a gift:**

1. If paintwork experiences spontaneous paint layer peeling covering an area of more than 3cm<sup>2</sup> within three months of purchasing the vehicle, it will be replaced. (Excluding man-made damage)
2. If the chrome plating layer of the electroplated parts falls off spontaneously within three months of purchasing the vehicle, covering an area of more than 1 cm<sup>2</sup>, it will be replaced. (Excluding any damage caused by human factors)
3. If the electronic instrument, speed control handle, or brake handle experiences a performance failure within six months and cannot be repaired to normal operation, it will be replaced.
4. If functional switches, power locks, speakers, flashers, DC converters, etc. experience performance failures within two months and cannot be restored to normal use after repair, they will be replaced.
5. If the aluminum rim, rear shock absorber, etc. experience performance failure within six months and cannot be used normally after repair, they will be replaced (excluding man-made damage)
6. If the seat cushion, rear rack, front and rear brakes, etc. experience performance failures within three months and cannot be repaired to normal use, they will be replaced. (Except for man-made damage)

**Remarks:**

1. When the user purchases the vehicle, the salesperson assists the user in completing the information of the user and the warranty unit in this warranty certificate. The original receipt is collected by the dealer and periodically sent back to our company to facilitate timely after-sales service for the product.
2. For malfunctions beyond the "three guarantees" scope and major components after the "three guarantees" period, our company is still responsible for repair, but charges will be applied according to the situation.
3. If the battery of an electric motorcycle experiences performance failure within six months and cannot be repaired to normal use, a new battery will be replaced within the first three months, and a maintenance battery will be replaced if it exceeds three months.
4. For battery replacements after the "three guarantees" period, our company will supply at a preferential price. However, old batteries must be recycled one-for-one and returned to the battery manufacturing plant to avoid environmental pollution.
5. The rear rack and toolbox are designed for users to conveniently store lightweight items (such as ponchos, books, etc.). For your safety, please avoid carrying passengers.
6. The service life of the entire vehicle is 10 years, and accessories will be provided for all sold vehicles within 10 years from the date of sale.

**It does not fall within the scope and content of the "three guarantees":**

1. Malfunctions caused by the user's failure to use, maintain, and adjust the product in accordance with the "Maintenance and Warranty Manual".
2. Damages caused by user-modified or dismantled repairs, as well as faults that have been decomposed by the user, resulting in original damage that cannot be technically identified and analyzed.
3. Malfunctions caused by improper use, improper storage, failure to maintain on schedule, or accidents.
4. Vehicles without a warranty card, or where the card, invoice, and actual product do not match.
5. Wear parts and consumables are not covered by the "three guarantees". This mainly refers to plastic parts, lamps, brake shoes, and wear parts not listed within the warranty scope.
6. Self-dismantled parts beyond the scope specified in the maintenance and warranty manual.
7. Expenses for repairs conducted without the consent of the authorized service station.
8. The economic and time losses caused by the vehicle's inability to function normally, as well as the losses due to inconvenience.
9. Damage caused by force majeure (such as fire, flood, earthquake, lightning strike, etc.).

**Main parameter specification table (JJ800WK-10)**

item.	Specification Project	Unit	parameter	item.	Specification Project	Unit	parameter
	L*W*H	mm			Motor model		
	Wheelbase	mm			Make		
	Minimum ground clearance	mm			Type		
	Mass in running order	kg			Manufacturing		
	Technically permissible maximum ladenmass	kg			Rated voltage	V	
	Brake type (front/rear)				Rated speed	r/min	
	Braking operation mode (front/rear)				Rated output torque	N.m	
	Rim size				Rated output power	Kw	
	Tyre size				Battery type		
	Pressure (kpa)	kPa			Rated capacity of battery	Ah	
	Transmission method				Nominal voltage of battery	V	
	maximum speed	km/h			Electricity consumption per 100 kilometers	Kw.h/100km	
	Driving range (working/equivalent)	km			Undervoltage protection value	V	
	gradability	(. )			Overcurrent protection value	A	
	Acceleration performance (0-100m)	S			Charger input power voltage/frequency	V/Hz	



**| Three | Pack Service | Registration | Card |**

Name		COC No.	
Landline		E-mail	
Cell NO.		Postal code	
Add.			
Type		Color	
Date of purchase		Invoice Number	
VIN		Motor NO.	
Battery NO.		Controller NO.	
Manufacturing		Distributor	
Contact number		Contact number	
Service Hotline		Service Hotline	

**\* Note: Please fill in the above content truthfully and in detail, and request the retailer to promptly return it to our company. Our company will register and file based on the above filled-in records, and provide a full set of free three-guarantee services.**

